

InPro 6850i Oxygen Sensor

Dissolved Oxygen Sensor Optimized for Bioprocesses



Save time with fast polarization

Fast startup with only one hour polarization greatly reduces maintenance time and increases availability.

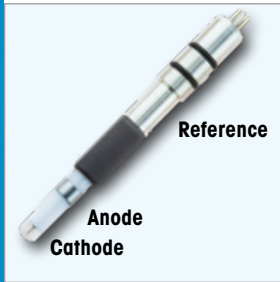

Highly reliable measurements with low drift technology

The unique three-electrode design eliminates electrolyte precipitation, minimizing drift and enhancing measurement performance.



Sensor for hygienic applications

The sensor fully complies with the EHEDG and FDA flat-surface recommendations for extremely high-level hygienic applications.

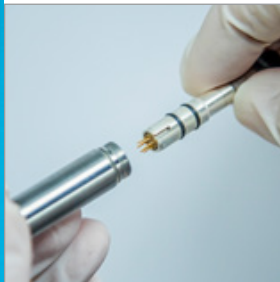

Modular design saves time

Replacement of the anode/cathode assembly is fast and simple: the quick-disconnect interior body can be replaced in less than 5 minutes.



USP
Class VI

FDA

A3

EHEDG
COMPANY MEMBER SINCE 1997

CE

Ex

FM
APPROVED

ISM®

InPro 6850i Polarographic Sensor Rapid Startup and Low Drift

The InPro® 6850i dissolved oxygen sensor provides best-in-class startup time combined with maximum accuracy and high cleanability. The sensor is suitable for large vessels and small vessels with limited space or containers with smaller volumes.

Intelligent Sensor Management (ISM®) diagnostic tools, including Dynamic Lifetime Indicator, optimize maintenance decisions and sensor lifetime.

The 316L stainless steel construction allows for CIP, steam sterilization or autoclaving-in-place.

FDA-compliant materials of construction and the easy-to-clean hygienically polished N5 grade surface finish satisfy regulatory requirements.

METTLER TOLEDO

Technical data of the InPro 6850i polarographic oxygen sensor

Segment/Application	Wide application range in pharmaceutical, food and beverage and chemical applications
Accuracy	±1 % +6 ppb
Sterilizable	Yes
Autoclavable	Yes
Material in contact with medium	Stainless steel (AISI 316L) with 3.1B certificates
Response time at 25 °C (air → N ₂)	90sec.
Mechanical pressure resistance	Max. 12 bar (174 psi) absolute
Detection range	6 ppb to saturation
ISM	Yes
ATEX Certification	SEV 14 ATEX 0169 XEx ia IIC T6/T5/T4/T3 Ga/Gb Ex ia IIIC T69oC/T81oC/T109oC/ T161oC Da/Db
IECEX Certificate of Conformity	IECEX SEV 14.0026XEx ia IIC T6/T5/T4/T3 Ga/Gb Ex ia IIIC T69oC/T81oC/T109oC/T161oC Da/Db
FM approval	IS/I, II, III/1/ABCDEF/T6
Description	Digital interface (ISM) with Dynamic Lifetime Indicator and Plug and Measure

Additional information

Digitally Compatible Transmitters

M800 Process 1-/2-/4-channel

M400 4-wire, HART™, FOUNDATION Fieldbus™

M400 2-wire, HART, FOUNDATION Fieldbus, PROFIBUS™ PA

M100SM 1-wire

Accessories

Order Nr.

CalBox™ (calibration box for calibration gas connection)	52 300 400
iSense™ 2.4	30 130 614
iSense 2.4 CFR	30 283 620

► www.mt.com/InPro6850i



iSense



M100SM 1-wire



CalBox

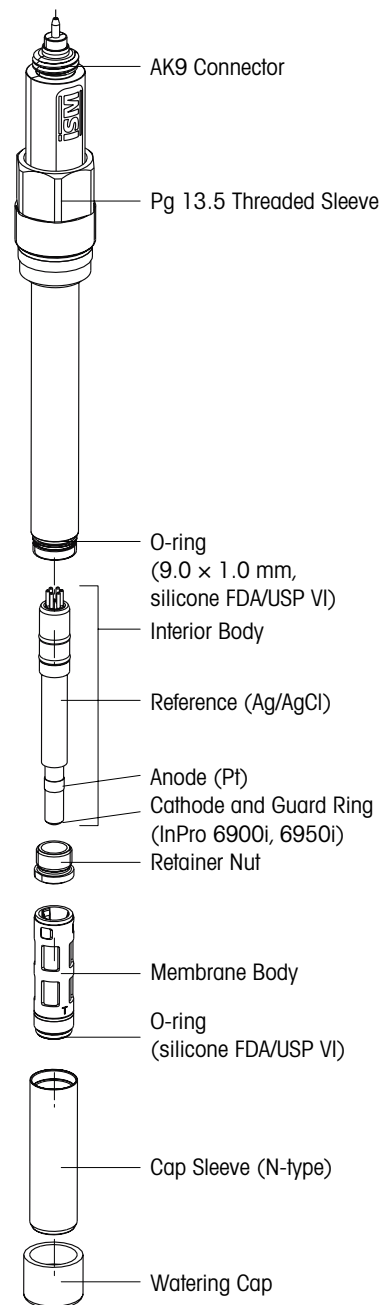

Construction drawing of the InPro 6850i

InPro, ISM, CalBox and iSense are trademarks of the METTLER TOLEDO Group. All other trademarks are the property of their respective owners.



Management System certified according to ISO 9001 / ISO 14001

METTLER TOLEDO Group

Process Analytics

Local contact: www.mt.com/pro-MOs

Subject to technical changes
© 12/2020 METTLER TOLEDO
All rights reserved. PA2084en A
MarCom Urdorf, CH

www.mt.com/pro

For more information